

Tuesday, July 30, 2019

Tim Grossi  
Contoocook Valley School District  
106 Hancock Road  
Peterborough NH 03458

**Project Name:** South Meadow Middle School

**Lab ID:** 19060242

**Project #:** N/A

**Date Received:** 6/25/2019

**Project Location:** SCH-22295

**Control #:** 19060242

Dear Tim Grossi

Enclosed please find the laboratory results for the above referenced samples that were received by the ChemServe sample custodian on the above referenced date. Any abnormalities to the samples upon receipt would be noted on the enclosed chain of custody document. This report is not valid without a completed chain of custody with the corresponding control number, attached.

All samples analyzed by ChemServe are subject to quality standards. These standards are as stringent or more stringent than those established under NELAC, 40 CFR Part 136, state certification programs, and corresponding methodologies. ChemServe has a written QA/QC Procedures Manual that outlines these standards, and is available for your reference, upon request. Unless otherwise stated on the Chain of Custody or within the report, all holding times, preservation techniques, container types, and analytical methods are analogous with those outlined by NELAC. All units are based on "as received" weight unless denoted "dry".

Residual chlorine, sulfite and pH are intended to be performed as an immediate field analysis. Should any of these analyses be performed in the lab instead of in the field it will result in those analyses being performed out of holding time.

Acrolein and 2-chloroethylvinyl ether require an additional analysis with an un-preserved sample. If unpreserved vials were not submitted for these additional analysis then acrolein and 2-CEVE are reported as estimated due to not meeting method requirements for EPA 624.1 or EPA 524.2.

I certify that I have reviewed the above referenced analytical data and state forms, and I have found this report within compliance with the procedures outlined within NELAC. ChemServe's certified parameter list can be found at <http://www.chemservelab.com/Laboratory-Information-and-Documentation.aspx>

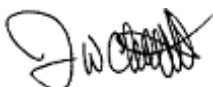

Jay Chrystal - President/Laboratory Director



Contoocook Valley School District  
 Tim Grossi  
 106 Hancock Road  
 Peterborough NH 03458

Control #: 19060242  
 Project Number: N/A  
 Project Name: South Meadow Middle School  
 Project Location: SCH-22295

Lab ID: 19060242  
 Date: 7/30/2019

Lab ID: 19060242

### Sample Receiving and Comment Summary

Were samples submitted with a chain of custody?	Yes
Do all samples received match the chain of custody?	Yes
Were all samples received within applicable holding times?	Yes
Were all containers intact when received?	Yes
Were samples for volatile organic analysis free of headspace (per method)?	N/A
Was there evidence of cooling if not submitted the same day as sampling?	Yes
If the sample pH was not correct was it adjusted where applicable?	Yes
Were samples for dissolved metals already filtered by the client or field sampling?	N/A
Were Samples for O-phos filtered in the field?	N/A
Were samples received in the appropriate containers?	Yes
Where applicable; were chemical and micro samples received at correct temps.	N/A

Sample	Method	Client Identity	Matrix	Analyst
19060242-001	EPA 200.5 Rev 4.2	Nurses Office Sink	Drinking Water	CharleneF

Comment: no comment

\* Blank comment sections denote "No Comment"



317 Elm Street  
 Milford, NH 03055  
 (603) 673-5440  
 Sales@chemservelab.com

Contocook Valley School District  
 Tim Grossi  
 106 Hancock Road  
 Peterborough NH 03458

Control #: 19060242  
 Project Number: N/A  
 Project Name: South Meadow Middle School  
 Project Location: SCH-22295

**Analytical Results**

Lab ID: 19060242  
 Date: 7/30/2019

Sample	Method	Client Sample Identity	Units	Matrix	Analyst
19060242-001	EPA 200.5 Rev 4.2	Nurses Office Sink		Drinking Water	CharleneF

Start Date/Time Sampled: 6/25/2019 8:47:00 AM Composite End Date/Time:

Parameter	CAS Number	Result	Qualifier	Date/Time Analyzed	RDL	Analyst
Hot Plate Digestion				7/11/2019	0	harleneF
Lead	7439-92-1	< 0.003 mg/L		7/22/2019	0.003	BenN

Sample	Method	Client Sample Identity	Units	Matrix	Analyst
19060242-002	EPA 200.5 Rev 4.2	Nurses office BR on rgt sink		Drinking Water	CharleneF

Start Date/Time Sampled: 6/25/2019 8:48:00 AM Composite End Date/Time:

Parameter	CAS Number	Result	Qualifier	Date/Time Analyzed	RDL	Analyst
Hot Plate Digestion				7/11/2019	0	harleneF
Lead	7439-92-1	0.004 mg/L		7/22/2019	0.003	BenN

Sample	Method	Client Sample Identity	Units	Matrix	Analyst
19060242-003	EPA 200.5 Rev 4.2	Nurses office BR on lft sink		Drinking Water	CharleneF

Start Date/Time Sampled: 6/25/2019 8:48:00 AM Composite End Date/Time:

Parameter	CAS Number	Result	Qualifier	Date/Time Analyzed	RDL	Analyst
Hot Plate Digestion				7/11/2019	0	harleneF
Lead	7439-92-1	0.003 mg/L		7/22/2019	0.003	BenN

Sample	Method	Client Sample Identity	Units	Matrix	Analyst
19060242-004	EPA 200.5 Rev 4.2	WF in office		Drinking Water	CharleneF

Start Date/Time Sampled: 6/25/2019 8:50:00 AM Composite End Date/Time:

Parameter	CAS Number	Result	Qualifier	Date/Time Analyzed	RDL	Analyst
Hot Plate Digestion				7/11/2019	0	harleneF
Lead	7439-92-1	< 0.003 mg/L		7/22/2019	0.003	BenN



317 Elm Street  
 Milford, NH 03055  
 (603) 673-5440  
 Sales@chemservelab.com

Sample	Method	Client Sample Identity	Units	Matrix	Analyst
19060242-005	EPA 200.5 Rev 4.2	Office kitchen sink		Drinking Water	CharleneF

Start Date/Time Sampled: 6/25/2019 8:52:00 AM Composite End Date/Time:

Parameter	CAS Number	Result	Qualifier	Date/Time Analyzed	RDL	Analyst
Hot Plate Digestion				7/11/2019	0	harleneF
Lead	7439-92-1	< 0.003 mg/L		7/22/2019	0.003	BenN

Sample	Method	Client Sample Identity	Units	Matrix	Analyst
19060242-007	EPA 200.5 Rev 4.2	Rm 36 BR sink		Drinking Water	CharleneF

Start Date/Time Sampled: 6/25/2019 8:54:00 AM Composite End Date/Time:

Parameter	CAS Number	Result	Qualifier	Date/Time Analyzed	RDL	Analyst
Hot Plate Digestion				7/11/2019	0	harleneF
Lead	7439-92-1	< 0.003 mg/L		7/22/2019	0.003	BenN

Sample	Method	Client Sample Identity	Units	Matrix	Analyst
19060242-008	EPA 200.5 Rev 4.2	Rm 36 sink		Drinking Water	CharleneF

Start Date/Time Sampled: 6/25/2019 8:51:00 AM Composite End Date/Time:

Parameter	CAS Number	Result	Qualifier	Date/Time Analyzed	RDL	Analyst
Hot Plate Digestion				7/11/2019	0	harleneF
Lead	7439-92-1	< 0.003 mg/L		7/22/2019	0.003	BenN

Sample	Method	Client Sample Identity	Units	Matrix	Analyst
19060242-009	EPA 200.5 Rev 4.2	Rm 54 sink		Drinking Water	CharleneF

Start Date/Time Sampled: 6/25/2019 9:26:00 AM Composite End Date/Time:

Parameter	CAS Number	Result	Qualifier	Date/Time Analyzed	RDL	Analyst
Hot Plate Digestion				7/11/2019	0	harleneF
Lead	7439-92-1	< 0.003 mg/L		7/22/2019	0.003	BenN

Sample	Method	Client Sample Identity	Units	Matrix	Analyst
19060242-010	EPA 200.5 Rev 4.2	WF next to Rm 53		Drinking Water	CharleneF

Start Date/Time Sampled: 6/25/2019 9:27:00 AM Composite End Date/Time:

Parameter	CAS Number	Result	Qualifier	Date/Time Analyzed	RDL	Analyst
Hot Plate Digestion				7/11/2019	0	harleneF
Lead	7439-92-1	< 0.003 mg/L		7/22/2019	0.003	BenN



317 Elm Street  
 Milford, NH 03055  
 (603) 673-5440  
 Sales@chemservelab.com

Sample	Method	Client Sample Identity	Units	Matrix	Analyst
19060242-011	EPA 200.5 Rev 4.2	WF next to Rm 52		Drinking Water	CharleneF

Start Date/Time Sampled: 6/25/2019 9:28:00 AM Composite End Date/Time:

Parameter	CAS Number	Result	Qualifier	Date/Time Analyzed	RDL	Analyst
Hot Plate Digestion				7/11/2019	0	harleneF
Lead	7439-92-1	< 0.003 mg/L		7/22/2019	0.003	BenN

Sample	Method	Client Sample Identity	Units	Matrix	Analyst
19060242-012	EPA 200.5 Rev 4.2	Bys BR nxt to Rm 53 snk lft		Drinking Water	CharleneF

Start Date/Time Sampled: 6/25/2019 9:35:00 AM Composite End Date/Time:

Parameter	CAS Number	Result	Qualifier	Date/Time Analyzed	RDL	Analyst
Hot Plate Digestion				7/11/2019	0	harleneF
Lead	7439-92-1	0.006 mg/L		7/22/2019	0.003	BenN

Sample	Method	Client Sample Identity	Units	Matrix	Analyst
19060242-013	EPA 200.5 Rev 4.2	Bys BR nxt to Rm 53 snk rgt		Drinking Water	CharleneF

Start Date/Time Sampled: 6/25/2019 9:35:00 AM Composite End Date/Time:

Parameter	CAS Number	Result	Qualifier	Date/Time Analyzed	RDL	Analyst
Hot Plate Digestion				7/11/2019	0	harleneF
Lead	7439-92-1	< 0.003 mg/L		7/22/2019	0.003	BenN

Sample	Method	Client Sample Identity	Units	Matrix	Analyst
19060242-014	EPA 200.5 Rev 4.2	Grls BR nxt to Rm 53 snk rgt		Drinking Water	CharleneF

Start Date/Time Sampled: 6/25/2019 9:37:00 AM Composite End Date/Time:

Parameter	CAS Number	Result	Qualifier	Date/Time Analyzed	RDL	Analyst
Hot Plate Digestion				7/11/2019	0	harleneF
Lead	7439-92-1	0.004 mg/L		7/22/2019	0.003	BenN

Sample	Method	Client Sample Identity	Units	Matrix	Analyst
19060242-015	EPA 200.5 Rev 4.2	Grls BR nxt to Rm53 snk2nd frm rgt		Drinking Water	CharleneF

Start Date/Time Sampled: 6/25/2019 9:37:00 AM Composite End Date/Time:

Parameter	CAS Number	Result	Qualifier	Date/Time Analyzed	RDL	Analyst
Hot Plate Digestion				7/11/2019	0	harleneF
Lead	7439-92-1	0.005 mg/L		7/22/2019	0.003	BenN



317 Elm Street  
 Milford, NH 03055  
 (603) 673-5440  
 Sales@chemservelab.com

Sample	Method	Client Sample Identity	Units	Matrix	Analyst
19060242-016	EPA 200.5 Rev 4.2	Grls BR nxt to Rm53 snk3rd frm rgt		Drinking Water	CharleneF

Start Date/Time Sampled: 6/25/2019 9:38:00 AM Composite End Date/Time:

Parameter	CAS Number	Result	Qualifier	Date/Time Analyzed	RDL	Analyst
Hot Plate Digestion				7/11/2019	0	harleneF
Lead	7439-92-1	0.010 mg/L		7/22/2019	0.003	BenN

Sample	Method	Client Sample Identity	Units	Matrix	Analyst
19060242-017	EPA 200.5 Rev 4.2	Grls BR nxt to Rm53 snk4th frm rgt		Drinking Water	CharleneF

Start Date/Time Sampled: 6/25/2019 9:38:00 AM Composite End Date/Time:

Parameter	CAS Number	Result	Qualifier	Date/Time Analyzed	RDL	Analyst
Hot Plate Digestion				7/11/2019	0	harleneF
Lead	7439-92-1	0.010 mg/L		7/22/2019	0.003	BenN

Sample	Method	Client Sample Identity	Units	Matrix	Analyst
19060242-018	EPA 200.5 Rev 4.2	Staff BR sink		Drinking Water	CharleneF

Start Date/Time Sampled: 6/25/2019 9:41:00 AM Composite End Date/Time:

Parameter	CAS Number	Result	Qualifier	Date/Time Analyzed	RDL	Analyst
Hot Plate Digestion				7/11/2019	0	harleneF
Lead	7439-92-1	< 0.003 mg/L		7/22/2019	0.003	BenN

Sample	Method	Client Sample Identity	Units	Matrix	Analyst
19060242-019	EPA 200.5 Rev 4.2	Boys Ctr BR sink		Drinking Water	CharleneF

Start Date/Time Sampled: 6/25/2019 9:23:00 AM Composite End Date/Time:

Parameter	CAS Number	Result	Qualifier	Date/Time Analyzed	RDL	Analyst
Hot Plate Digestion				7/11/2019	0	harleneF
Lead	7439-92-1	0.006 mg/L		7/22/2019	0.003	BenN

Sample	Method	Client Sample Identity	Units	Matrix	Analyst
19060242-020	EPA 200.5 Rev 4.2	Girls Ctr BR sink on lft		Drinking Water	CharleneF

Start Date/Time Sampled: 6/25/2019 9:24:00 AM Composite End Date/Time:

Parameter	CAS Number	Result	Qualifier	Date/Time Analyzed	RDL	Analyst
Hot Plate Digestion				7/11/2019	0	harleneF
Lead	7439-92-1	0.004 mg/L		7/22/2019	0.003	BenN

Sample	Method	Client Sample Identity	Units	Matrix	Analyst
19060242-021	EPA 200.5 Rev 4.2	Girls Ctr BR sink on rgt		Drinking Water	CharleneF

Start Date/Time Sampled: 6/25/2019 9:24:00 AM Composite End Date/Time:

Parameter	CAS Number	Result	Qualifier	Date/Time Analyzed	RDL	Analyst
Hot Plate Digestion				7/11/2019	0	harleneF
Lead	7439-92-1	0.010 mg/L		7/22/2019	0.003	BenN

Sample	Method	Client Sample Identity	Units	Matrix	Analyst
19060242-022	EPA 200.5 Rev 4.2	Tchrs Rm sink		Drinking Water	CharleneF

Start Date/Time Sampled: 6/25/2019 9:33:00 AM Composite End Date/Time:

Parameter	CAS Number	Result	Qualifier	Date/Time Analyzed	RDL	Analyst
Hot Plate Digestion				7/11/2019	0	harleneF
Lead	7439-92-1	0.004 mg/L		7/22/2019	0.003	BenN

Sample	Method	Client Sample Identity	Units	Matrix	Analyst
19060242-023	EPA 200.5 Rev 4.2	SAU Kitchen sink		Drinking Water	CharleneF

Start Date/Time Sampled: 6/25/2019 9:16:00 AM Composite End Date/Time:

Parameter	CAS Number	Result	Qualifier	Date/Time Analyzed	RDL	Analyst
Hot Plate Digestion				7/11/2019	0	harleneF
Lead	7439-92-1	< 0.003 mg/L		7/22/2019	0.003	BenN

Sample	Method	Client Sample Identity	Units	Matrix	Analyst
19060242-024	EPA 200.5 Rev 4.2	SAU Kitchen BR sink		Drinking Water	CharleneF

Start Date/Time Sampled: 6/25/2019 9:06:00 AM Composite End Date/Time:

Parameter	CAS Number	Result	Qualifier	Date/Time Analyzed	RDL	Analyst
Hot Plate Digestion				7/11/2019	0	harleneF
Lead	7439-92-1	0.007 mg/L		7/22/2019	0.003	BenN

Sample	Method	Client Sample Identity	Units	Matrix	Analyst
19060242-025	EPA 200.5 Rev 4.2	WF in SAU		Drinking Water	CharleneF

Start Date/Time Sampled: 6/25/2019 9:05:00 AM Composite End Date/Time:

Parameter	CAS Number	Result	Qualifier	Date/Time Analyzed	RDL	Analyst
Hot Plate Digestion				7/11/2019	0	harleneF
Lead	7439-92-1	< 0.003 mg/L		7/22/2019	0.003	BenN

Sample	Method	Client Sample Identity	Units	Matrix	Analyst
19060242-026	EPA 200.5 Rev 4.2	SAU Mens BR sink on rgt		Drinking Water	CharleneF

Start Date/Time Sampled: 6/25/2019 9:08:00 AM Composite End Date/Time:

Parameter	CAS Number	Result	Qualifier	Date/Time Analyzed	RDL	Analyst
Hot Plate Digestion				7/11/2019	0	harleneF
Lead	7439-92-1	0.008 mg/L		7/22/2019	0.003	BenN

Sample	Method	Client Sample Identity	Units	Matrix	Analyst
19060242-027	EPA 200.5 Rev 4.2	SAU Mns BR snk 2nd frm rgt		Drinking Water	CharleneF

Start Date/Time Sampled: 6/25/2019 9:08:00 AM Composite End Date/Time:

Parameter	CAS Number	Result	Qualifier	Date/Time Analyzed	RDL	Analyst
Hot Plate Digestion				7/11/2019	0	harleneF
Lead	7439-92-1	0.015 mg/L		7/22/2019	0.003	BenN

Sample	Method	Client Sample Identity	Units	Matrix	Analyst
19060242-028	EPA 200.5 Rev 4.2	SAU Mns BR snk 3rd frm rgt		Drinking Water	CharleneF

Start Date/Time Sampled: 6/25/2019 9:08:00 AM Composite End Date/Time:

Parameter	CAS Number	Result	Qualifier	Date/Time Analyzed	RDL	Analyst
Hot Plate Digestion				7/11/2019	0	harleneF
Lead	7439-92-1	0.014 mg/L		7/22/2019	0.003	BenN

Sample	Method	Client Sample Identity	Units	Matrix	Analyst
19060242-029	EPA 200.5 Rev 4.2	SAU Mens BR snk 4th frm rgt		Drinking Water	CharleneF

Start Date/Time Sampled: 6/25/2019 9:09:00 AM Composite End Date/Time:

Parameter	CAS Number	Result	Qualifier	Date/Time Analyzed	RDL	Analyst
Hot Plate Digestion				7/11/2019	0	harleneF
Lead	7439-92-1	< 0.003 mg/L		7/22/2019	0.003	BenN

Sample	Method	Client Sample Identity	Units	Matrix	Analyst
19060242-030	EPA 200.5 Rev 4.2	SAU Mens BR snk 5th frm rgt		Drinking Water	CharleneF

Start Date/Time Sampled: 6/25/2019 9:09:00 AM Composite End Date/Time:

Parameter	CAS Number	Result	Qualifier	Date/Time Analyzed	RDL	Analyst
Hot Plate Digestion				7/11/2019	0	harleneF
Lead	7439-92-1	0.005 mg/L		7/22/2019	0.003	BenN





317 Elm Street  
 Milford, NH 03055  
 (603) 673-5440  
 Sales@chemservelab.com

Sample	Method	Client Sample Identity	Units	Matrix	Analyst
19060242-031	EPA 200.5 Rev 4.2	SAU Wmns BR snk 5th frm rgt		Drinking Water	CharleneF

Start Date/Time Sampled: 6/25/2019 9:19:00 AM Composite End Date/Time:

Parameter	CAS Number	Result	Qualifier	Date/Time Analyzed	RDL	Analyst
Hot Plate Digestion				7/11/2019	0	harleneF
Lead	7439-92-1	0.004 mg/L		7/22/2019	0.003	BenN

Sample	Method	Client Sample Identity	Units	Matrix	Analyst
19060242-032	EPA 200.5 Rev 4.2	SAU Wmns BR snk 4th frm rgt		Drinking Water	CharleneF

Start Date/Time Sampled: 6/25/2019 9:18:00 AM Composite End Date/Time:

Parameter	CAS Number	Result	Qualifier	Date/Time Analyzed	RDL	Analyst
Hot Plate Digestion				7/11/2019	0	harleneF
Lead	7439-92-1	0.005 mg/L		7/22/2019	0.003	BenN

Sample	Method	Client Sample Identity	Units	Matrix	Analyst
19060242-033	EPA 200.5 Rev 4.2	SAU Wmns BR snk 3rd frm rgt		Drinking Water	CharleneF

Start Date/Time Sampled: 6/25/2019 9:19:00 AM Composite End Date/Time:

Parameter	CAS Number	Result	Qualifier	Date/Time Analyzed	RDL	Analyst
Hot Plate Digestion				7/11/2019	0	harleneF
Lead	7439-92-1	0.009 mg/L		7/22/2019	0.003	BenN

Sample	Method	Client Sample Identity	Units	Matrix	Analyst
19060242-034	EPA 200.5 Rev 4.2	SAU Wmns BR snk 2nd frm rgt		Drinking Water	CharleneF

Start Date/Time Sampled: 6/25/2019 9:16:00 AM Composite End Date/Time:

Parameter	CAS Number	Result	Qualifier	Date/Time Analyzed	RDL	Analyst
Hot Plate Digestion				7/11/2019	0	harleneF
Lead	7439-92-1	0.003 mg/L		7/22/2019	0.003	BenN

Sample	Method	Client Sample Identity	Units	Matrix	Analyst
19060242-035	EPA 200.5 Rev 4.2	SAU Wmns BR snk on rgt		Drinking Water	CharleneF

Start Date/Time Sampled: 6/25/2019 9:18:00 AM Composite End Date/Time:

Parameter	CAS Number	Result	Qualifier	Date/Time Analyzed	RDL	Analyst
Hot Plate Digestion				7/11/2019	0	harleneF
Lead	7439-92-1	0.010 mg/L		7/22/2019	0.003	BenN



317 Elm Street  
 Milford, NH 03055  
 (603) 673-5440  
 Sales@chemservelab.com

Sample	Method	Client Sample Identity	Units	Matrix	Analyst
19060242-036	EPA 200.5 Rev 4.2	Library BR sink		Drinking Water	CharleneF

Start Date/Time Sampled: 6/25/2019 8:57:00 AM Composite End Date/Time:

Parameter	CAS Number	Result	Qualifier	Date/Time Analyzed	RDL	Analyst
Hot Plate Digestion				7/11/2019	0	harleneF
Lead	7439-92-1	< 0.003 mg/L		7/22/2019	0.003	BenN

Sample	Method	Client Sample Identity	Units	Matrix	Analyst
19060242-038	EPA 200.5 Rev 4.2	WF in Library		Drinking Water	CharleneF

Start Date/Time Sampled: 6/25/2019 8:58:00 AM Composite End Date/Time:

Parameter	CAS Number	Result	Qualifier	Date/Time Analyzed	RDL	Analyst
Hot Plate Digestion				7/11/2019	0	harleneF
Lead	7439-92-1	< 0.003 mg/L		7/22/2019	0.003	BenN

Sample	Method	Client Sample Identity	Units	Matrix	Analyst
19060242-039	EPA 200.5 Rev 4.2	Rm 1 W sink		Drinking Water	CharleneF

Start Date/Time Sampled: 6/25/2019 9:48:00 AM Composite End Date/Time:

Parameter	CAS Number	Result	Qualifier	Date/Time Analyzed	RDL	Analyst
Hot Plate Digestion				7/11/2019	0	harleneF
Lead	7439-92-1	< 0.003 mg/L		7/22/2019	0.003	BenN

Sample	Method	Client Sample Identity	Units	Matrix	Analyst
19060242-040	EPA 200.5 Rev 4.2	Rm 1 Ctr sink		Drinking Water	CharleneF

Start Date/Time Sampled: 6/25/2019 9:49:00 AM Composite End Date/Time:

Parameter	CAS Number	Result	Qualifier	Date/Time Analyzed	RDL	Analyst
Hot Plate Digestion				7/11/2019	0	harleneF
Lead	7439-92-1	0.009 mg/L		7/22/2019	0.003	BenN

Sample	Method	Client Sample Identity	Units	Matrix	Analyst
19060242-041	EPA 200.5 Rev 4.2	Rm 1 E sink		Drinking Water	CharleneF

Start Date/Time Sampled: 6/25/2019 9:48:00 AM Composite End Date/Time:

Parameter	CAS Number	Result	Qualifier	Date/Time Analyzed	RDL	Analyst
Hot Plate Digestion				7/11/2019	0	harleneF
Lead	7439-92-1	< 0.003 mg/L		7/22/2019	0.003	BenN

Sample	Method	Client Sample Identity	Units	Matrix	Analyst
19060242-042	EPA 200.5 Rev 4.2	Rm 2 S sink	mg/L	Drinking Water	BenN

Start Date/Time Sampled: 6/25/2019 9:32:00 AM Composite End Date/Time:

Parameter	CAS Number	Result	Qualifier	Date/Time Analyzed	RDL	Analyst
Lead	7439-92-1	0.003 mg/L		7/22/2019	0.003	BenN

Sample	Method	Client Sample Identity	Units	Matrix	Analyst
19060242-042	EPA 200.7	Rm 2 S sink		Drinking Water	CharleneF

Start Date/Time Sampled: 6/25/2019 9:32:00 AM Composite End Date/Time:

Parameter	CAS Number	Result	Qualifier	Date/Time Analyzed	RDL	Analyst
Hot Plate Digestion				7/11/2019	0	harleneF

Sample	Method	Client Sample Identity	Units	Matrix	Analyst
19060242-043	EPA 200.5 Rev 4.2	Rm 2 N sink		Drinking Water	CharleneF

Start Date/Time Sampled: 6/25/2019 9:31:00 AM Composite End Date/Time:

Parameter	CAS Number	Result	Qualifier	Date/Time Analyzed	RDL	Analyst
Hot Plate Digestion				7/11/2019	0	harleneF
Lead	7439-92-1	0.004 mg/L		7/22/2019	0.003	BenN

Sample	Method	Client Sample Identity	Units	Matrix	Analyst
19060242-044	EPA 200.5 Rev 4.2	Rm 2 Tchrs sink		Drinking Water	CharleneF

Start Date/Time Sampled: 6/25/2019 9:30:00 AM Composite End Date/Time:

Parameter	CAS Number	Result	Qualifier	Date/Time Analyzed	RDL	Analyst
Hot Plate Digestion				7/11/2019	0	harleneF
Lead	7439-92-1	0.008 mg/L		7/22/2019	0.003	BenN

Sample	Method	Client Sample Identity	Units	Matrix	Analyst
19060242-046	EPA 200.5 Rev 4.2	Rm 3 NW sink		Drinking Water	CharleneF

Start Date/Time Sampled: 6/25/2019 9:21:00 AM Composite End Date/Time:

Parameter	CAS Number	Result	Qualifier	Date/Time Analyzed	RDL	Analyst
Hot Plate Digestion				7/11/2019	0	harleneF
Lead	7439-92-1	< 0.003 mg/L		7/22/2019	0.003	BenN



317 Elm Street  
 Milford, NH 03055  
 (603) 673-5440  
 Sales@chemservelab.com

Sample	Method	Client Sample Identity	Units	Matrix	Analyst
19060242-047	EPA 200.5 Rev 4.2	Rm 3 NE sink		Drinking Water	CharleneF

Start Date/Time Sampled: 6/25/2019 9:24:00 AM Composite End Date/Time:

Parameter	CAS Number	Result	Qualifier	Date/Time Analyzed	RDL	Analyst
Hot Plate Digestion				7/11/2019	0	harleneF
Lead	7439-92-1	< 0.003 mg/L		7/22/2019	0.003	BenN

Sample	Method	Client Sample Identity	Units	Matrix	Analyst
19060242-048	EPA 200.5 Rev 4.2	Rm 3 N Ctr sink		Drinking Water	CharleneF

Start Date/Time Sampled: 6/25/2019 9:24:00 AM Composite End Date/Time:

Parameter	CAS Number	Result	Qualifier	Date/Time Analyzed	RDL	Analyst
Hot Plate Digestion				7/11/2019	0	harleneF
Lead	7439-92-1	< 0.003 mg/L		7/22/2019	0.003	BenN

Sample	Method	Client Sample Identity	Units	Matrix	Analyst
19060242-049	EPA 200.5 Rev 4.2	Rm 3 SW sink		Drinking Water	CharleneF

Start Date/Time Sampled: 6/25/2019 9:24:00 AM Composite End Date/Time:

Parameter	CAS Number	Result	Qualifier	Date/Time Analyzed	RDL	Analyst
Hot Plate Digestion				7/11/2019	0	harleneF
Lead	7439-92-1	< 0.003 mg/L		7/22/2019	0.003	BenN

Sample	Method	Client Sample Identity	Units	Matrix	Analyst
19060242-050	EPA 200.5 Rev 4.2	Rm 3 SE sink		Drinking Water	CharleneF

Start Date/Time Sampled: 6/25/2019 9:25:00 AM Composite End Date/Time:

Parameter	CAS Number	Result	Qualifier	Date/Time Analyzed	RDL	Analyst
Hot Plate Digestion				7/11/2019	0	harleneF
Lead	7439-92-1	0.020 mg/L		7/22/2019	0.003	BenN

Sample	Method	Client Sample Identity	Units	Matrix	Analyst
19060242-051	EPA 200.5 Rev 4.2	Rm 20 sink on lft		Drinking Water	CharleneF

Start Date/Time Sampled: 6/25/2019 9:14:00 AM Composite End Date/Time:

Parameter	CAS Number	Result	Qualifier	Date/Time Analyzed	RDL	Analyst
Hot Plate Digestion				7/11/2019	0	harleneF
Lead	7439-92-1	< 0.003 mg/L		7/22/2019	0.003	BenN



317 Elm Street  
 Milford, NH 03055  
 (603) 673-5440  
 Sales@chemservelab.com

Sample	Method	Client Sample Identity	Units	Matrix	Analyst
19060242-052	EPA 200.5 Rev 4.2	Rm 20 sink on rgt		Drinking Water	CharleneF

Start Date/Time Sampled: 6/25/2019 9:14:00 AM Composite End Date/Time:

Parameter	CAS Number	Result	Qualifier	Date/Time Analyzed	RDL	Analyst
Hot Plate Digestion				7/11/2019	0	harleneF
Lead	7439-92-1	0.006 mg/L		7/22/2019	0.003	BenN

Sample	Method	Client Sample Identity	Units	Matrix	Analyst
19060242-053	EPA 200.5 Rev 4.2	Staff BR in 8th gr wing sink		Drinking Water	CharleneF

Start Date/Time Sampled: 6/25/2019 9:20:00 AM Composite End Date/Time:

Parameter	CAS Number	Result	Qualifier	Date/Time Analyzed	RDL	Analyst
Hot Plate Digestion				7/11/2019	0	harleneF
Lead	7439-92-1	< 0.003 mg/L		7/22/2019	0.003	BenN

Sample	Method	Client Sample Identity	Units	Matrix	Analyst
19060242-054	EPA 200.5 Rev 4.2	8th grd WF Bottle		Drinking Water	CharleneF

Start Date/Time Sampled: 6/25/2019 8:56:00 AM Composite End Date/Time:

Parameter	CAS Number	Result	Qualifier	Date/Time Analyzed	RDL	Analyst
Hot Plate Digestion				7/11/2019	0	harleneF
Lead	7439-92-1	< 0.003 mg/L		7/22/2019	0.003	BenN

Sample	Method	Client Sample Identity	Units	Matrix	Analyst
19060242-055	EPA 200.5 Rev 4.2	Kitch Laundry Snk		Drinking Water	CharleneF

Start Date/Time Sampled: 6/25/2019 10:30:00 AM Composite End Date/Time:

Parameter	CAS Number	Result	Qualifier	Date/Time Analyzed	RDL	Analyst
Hot Plate Digestion				7/11/2019	0	harleneF
Lead	7439-92-1	< 0.003 mg/L		7/22/2019	0.003	BenN

Sample	Method	Client Sample Identity	Units	Matrix	Analyst
19060242-056	EPA 200.5 Rev 4.2	Rm 4 sink on rgt		Drinking Water	CharleneF

Start Date/Time Sampled: 6/25/2019 9:10:00 AM Composite End Date/Time:

Parameter	CAS Number	Result	Qualifier	Date/Time Analyzed	RDL	Analyst
Hot Plate Digestion				7/11/2019	0	harleneF
Lead	7439-92-1	< 0.003 mg/L		7/22/2019	0.003	BenN

Sample	Method	Client Sample Identity	Units	Matrix	Analyst
19060242-057	EPA 200.5 Rev 4.2	Rm 4 sink on lft		Drinking Water	CharleneF

Start Date/Time Sampled: 6/25/2019 9:10:00 AM Composite End Date/Time:

Parameter	CAS Number	Result	Qualifier	Date/Time Analyzed	RDL	Analyst
Hot Plate Digestion				7/11/2019	0	harleneF
Lead	7439-92-1	< 0.003 mg/L		7/22/2019	0.003	BenN

Sample	Method	Client Sample Identity	Units	Matrix	Analyst
19060242-058	EPA 200.5 Rev 4.2	Rm 12 NW sink		Drinking Water	CharleneF

Start Date/Time Sampled: 6/25/2019 9:55:00 AM Composite End Date/Time:

Parameter	CAS Number	Result	Qualifier	Date/Time Analyzed	RDL	Analyst
Hot Plate Digestion				7/11/2019	0	harleneF
Lead	7439-92-1	< 0.003 mg/L		7/22/2019	0.003	BenN

Sample	Method	Client Sample Identity	Units	Matrix	Analyst
19060242-059	EPA 200.5 Rev 4.2	Rm 12 NE sink		Drinking Water	CharleneF

Start Date/Time Sampled: 6/25/2019 9:55:00 AM Composite End Date/Time:

Parameter	CAS Number	Result	Qualifier	Date/Time Analyzed	RDL	Analyst
Hot Plate Digestion				7/11/2019	0	harleneF
Lead	7439-92-1	0.010 mg/L		7/22/2019	0.003	BenN

Sample	Method	Client Sample Identity	Units	Matrix	Analyst
19060242-060	EPA 200.5 Rev 4.2	Rm 12 SE sink		Drinking Water	CharleneF

Start Date/Time Sampled: 6/25/2019 9:56:00 AM Composite End Date/Time:

Parameter	CAS Number	Result	Qualifier	Date/Time Analyzed	RDL	Analyst
Hot Plate Digestion				7/11/2019	0	harleneF
Lead	7439-92-1	0.004 mg/L		7/22/2019	0.003	BenN

Sample	Method	Client Sample Identity	Units	Matrix	Analyst
19060242-061	EPA 200.5 Rev 4.2	Rm 12 SW sink		Drinking Water	CharleneF

Start Date/Time Sampled: 6/25/2019 9:56:00 AM Composite End Date/Time:

Parameter	CAS Number	Result	Qualifier	Date/Time Analyzed	RDL	Analyst
Hot Plate Digestion				7/11/2019	0	harleneF
Lead	7439-92-1	< 0.003 mg/L		7/22/2019	0.003	BenN

Sample	Method	Client Sample Identity	Units	Matrix	Analyst
19060242-062	EPA 200.5 Rev 4.2	Rm 12 Tchrs sink		Drinking Water	CharleneF

Start Date/Time Sampled: 6/25/2019 9:57:00 AM Composite End Date/Time:

Parameter	CAS Number	Result	Qualifier	Date/Time Analyzed	RDL	Analyst
Hot Plate Digestion				7/11/2019	0	harleneF
Lead	7439-92-1	0.190 mg/L		7/22/2019	0.003	BenN

Sample	Method	Client Sample Identity	Units	Matrix	Analyst
19060242-063	EPA 200.5 Rev 4.2	Rm 22 rgt sink		Drinking Water	CharleneF

Start Date/Time Sampled: 6/25/2019 10:00:00 AM Composite End Date/Time:

Parameter	CAS Number	Result	Qualifier	Date/Time Analyzed	RDL	Analyst
Hot Plate Digestion				7/11/2019	0	harleneF
Lead	7439-92-1	0.004 mg/L		7/22/2019	0.003	BenN

Sample	Method	Client Sample Identity	Units	Matrix	Analyst
19060242-064	EPA 200.5 Rev 4.2	Rm 22 lft sink		Drinking Water	CharleneF

Start Date/Time Sampled: 6/25/2019 10:00:00 AM Composite End Date/Time:

Parameter	CAS Number	Result	Qualifier	Date/Time Analyzed	RDL	Analyst
Hot Plate Digestion				7/11/2019	0	harleneF
Lead	7439-92-1	0.020 mg/L		7/22/2019	0.003	BenN

Sample	Method	Client Sample Identity	Units	Matrix	Analyst
19060242-065	EPA 200.5 Rev 4.2	Rm 13 NW sink		Drinking Water	CharleneF

Start Date/Time Sampled: 6/25/2019 10:02:00 AM Composite End Date/Time:

Parameter	CAS Number	Result	Qualifier	Date/Time Analyzed	RDL	Analyst
Hot Plate Digestion				7/11/2019	0	harleneF
Lead	7439-92-1	< 0.003 mg/L		7/22/2019	0.003	BenN

Sample	Method	Client Sample Identity	Units	Matrix	Analyst
19060242-066	EPA 200.5 Rev 4.2	Rm 13 NE sink		Drinking Water	CharleneF

Start Date/Time Sampled: 6/25/2019 10:02:00 AM Composite End Date/Time:

Parameter	CAS Number	Result	Qualifier	Date/Time Analyzed	RDL	Analyst
Hot Plate Digestion				7/11/2019	0	harleneF
Lead	7439-92-1	< 0.003 mg/L		7/22/2019	0.003	BenN



317 Elm Street  
 Milford, NH 03055  
 (603) 673-5440  
 Sales@chemservelab.com

Sample	Method	Client Sample Identity	Units	Matrix	Analyst
19060242-067	EPA 200.5 Rev 4.2	Rm 13 SE sink		Drinking Water	CharleneF

Start Date/Time Sampled: 6/25/2019 10:03:00 AM Composite End Date/Time:

Parameter	CAS Number	Result	Qualifier	Date/Time Analyzed	RDL	Analyst
Hot Plate Digestion				7/11/2019	0	harleneF
Lead	7439-92-1	< 0.003 mg/L		7/22/2019	0.003	BenN

Sample	Method	Client Sample Identity	Units	Matrix	Analyst
19060242-068	EPA 200.5 Rev 4.2	Rm 13 SW sink		Drinking Water	CharleneF

Start Date/Time Sampled: 6/25/2019 10:03:00 AM Composite End Date/Time:

Parameter	CAS Number	Result	Qualifier	Date/Time Analyzed	RDL	Analyst
Hot Plate Digestion				7/11/2019	0	harleneF
Lead	7439-92-1	< 0.003 mg/L		7/22/2019	0.003	BenN

Sample	Method	Client Sample Identity	Units	Matrix	Analyst
19060242-069	EPA 200.5 Rev 4.2	Rm 13 Tchrs/Ctr sink		Drinking Water	CharleneF

Start Date/Time Sampled: 6/25/2019 10:07:00 AM Composite End Date/Time:

Parameter	CAS Number	Result	Qualifier	Date/Time Analyzed	RDL	Analyst
Hot Plate Digestion				7/11/2019	0	harleneF
Lead	7439-92-1	< 0.003 mg/L		7/22/2019	0.003	BenN

Sample	Method	Client Sample Identity	Units	Matrix	Analyst
19060242-070	EPA 200.5 Rev 4.2	Staff Kitchen sink		Drinking Water	CharleneF

Start Date/Time Sampled: 6/25/2019 10:22:00 AM Composite End Date/Time:

Parameter	CAS Number	Result	Qualifier	Date/Time Analyzed	RDL	Analyst
Hot Plate Digestion				7/11/2019	0	harleneF
Lead	7439-92-1	< 0.003 mg/L		7/22/2019	0.003	BenN

Sample	Method	Client Sample Identity	Units	Matrix	Analyst
19060242-071	EPA 200.5 Rev 4.2	Staff BR sink in staff kitchen		Drinking Water	CharleneF

Start Date/Time Sampled: 6/25/2019 10:22:00 AM Composite End Date/Time:

Parameter	CAS Number	Result	Qualifier	Date/Time Analyzed	RDL	Analyst
Hot Plate Digestion				7/11/2019	0	harleneF
Lead	7439-92-1	< 0.003 mg/L		7/22/2019	0.003	BenN





317 Elm Street  
 Milford, NH 03055  
 (603) 673-5440  
 Sales@chemservelab.com

Sample	Method	Client Sample Identity	Units	Matrix	Analyst
19060242-072	EPA 200.5 Rev 4.2	kitchen 3 bay sink RT		Drinking Water	CharleneF

Start Date/Time Sampled: 6/25/2019 10:30:00 AM Composite End Date/Time:

Parameter	CAS Number	Result	Qualifier	Date/Time Analyzed	RDL	Analyst
Hot Plate Digestion				7/11/2019	0	harleneF
Lead	7439-92-1	< 0.003 mg/L		7/22/2019	0.003	BenN

Sample	Method	Client Sample Identity	Units	Matrix	Analyst
19060242-073	EPA 200.5 Rev 4.2	3 bay sink in kitchen Lft		Drinking Water	CharleneF

Start Date/Time Sampled: 6/25/2019 10:30:00 AM Composite End Date/Time:

Parameter	CAS Number	Result	Qualifier	Date/Time Analyzed	RDL	Analyst
Hot Plate Digestion				7/11/2019	0	harleneF
Lead	7439-92-1	< 0.003 mg/L		7/22/2019	0.003	BenN

Sample	Method	Client Sample Identity	Units	Matrix	Analyst
19060242-074	EPA 200.5 Rev 4.2	kitchen rinse sink		Drinking Water	CharleneF

Start Date/Time Sampled: 6/25/2019 10:27:00 AM Composite End Date/Time:

Parameter	CAS Number	Result	Qualifier	Date/Time Analyzed	RDL	Analyst
Hot Plate Digestion				7/11/2019	0	harleneF
Lead	7439-92-1	< 0.003 mg/L		7/22/2019	0.003	BenN

Sample	Method	Client Sample Identity	Units	Matrix	Analyst
19060242-075	EPA 200.5 Rev 4.2	kitchen hand wash sink		Drinking Water	CharleneF

Start Date/Time Sampled: 6/25/2019 10:32:00 AM Composite End Date/Time:

Parameter	CAS Number	Result	Qualifier	Date/Time Analyzed	RDL	Analyst
Hot Plate Digestion				7/11/2019	0	harleneF
Lead	7439-92-1	< 0.003 mg/L		7/22/2019	0.003	BenN

Sample	Method	Client Sample Identity	Units	Matrix	Analyst
19060242-076	EPA 200.5 Rev 4.2	Rm 37 N sink		Drinking Water	CharleneF

Start Date/Time Sampled: 6/25/2019 10:08:00 AM Composite End Date/Time:

Parameter	CAS Number	Result	Qualifier	Date/Time Analyzed	RDL	Analyst
Hot Plate Digestion				7/11/2019	0	harleneF
Lead	7439-92-1	< 0.003 mg/L		7/22/2019	0.003	BenN

Sample	Method	Client Sample Identity	Units	Matrix	Analyst
19060242-077	EPA 200.5 Rev 4.2	Rm 37 S sink		Drinking Water	CharleneF

Start Date/Time Sampled: 6/25/2019 10:08:00 AM Composite End Date/Time:

Parameter	CAS Number	Result	Qualifier	Date/Time Analyzed	RDL	Analyst
Hot Plate Digestion				7/11/2019	0	harleneF
Lead	7439-92-1	< 0.003 mg/L		7/22/2019	0.003	BenN

Sample	Method	Client Sample Identity	Units	Matrix	Analyst
19060242-078	EPA 200.5 Rev 4.2	gym BR wash basin		Drinking Water	CharleneF

Start Date/Time Sampled: 6/25/2019 10:11:00 AM Composite End Date/Time:

Parameter	CAS Number	Result	Qualifier	Date/Time Analyzed	RDL	Analyst
Hot Plate Digestion				7/11/2019	0	harleneF
Lead	7439-92-1	< 0.003 mg/L		7/22/2019	0.003	BenN

Sample	Method	Client Sample Identity	Units	Matrix	Analyst
19060242-079	EPA 200.5 Rev 4.2	gym BR WF		Drinking Water	CharleneF

Start Date/Time Sampled: 6/25/2019 10:11:00 AM Composite End Date/Time:

Parameter	CAS Number	Result	Qualifier	Date/Time Analyzed	RDL	Analyst
Hot Plate Digestion				7/11/2019	0	harleneF
Lead	7439-92-1	< 0.003 mg/L		7/22/2019	0.003	BenN

Sample	Method	Client Sample Identity	Units	Matrix	Analyst
19060242-080	EPA 200.5 Rev 4.2	gym WF		Drinking Water	CharleneF

Start Date/Time Sampled: 6/25/2019 10:13:00 AM Composite End Date/Time:

Parameter	CAS Number	Result	Qualifier	Date/Time Analyzed	RDL	Analyst
Hot Plate Digestion				7/11/2019	0	harleneF
Lead	7439-92-1	< 0.003 mg/L		7/22/2019	0.003	BenN

Sample	Method	Client Sample Identity	Units	Matrix	Analyst
19060242-081	EPA 200.5 Rev 4.2	boys locker Rm BR sink		Drinking Water	CharleneF

Start Date/Time Sampled: 6/25/2019 10:36:00 AM Composite End Date/Time:

Parameter	CAS Number	Result	Qualifier	Date/Time Analyzed	RDL	Analyst
Hot Plate Digestion				7/11/2019	0	harleneF
Lead	7439-92-1	0.006 mg/L		7/22/2019	0.003	BenN



317 Elm Street  
 Milford, NH 03055  
 (603) 673-5440  
 Sales@chemservelab.com

Sample	Method	Client Sample Identity	Units	Matrix	Analyst
19060242-082	EPA 200.5 Rev 4.2	girls locker Rm BR sink		Drinking Water	CharleneF

Start Date/Time Sampled: 6/25/2019 10:35:00 AM Composite End Date/Time:

Parameter	CAS Number	Result	Qualifier	Date/Time Analyzed	RDL	Analyst
Hot Plate Digestion				7/11/2019	0	harleneF
Lead	7439-92-1	< 0.003 mg/L		7/22/2019	0.003	BenN

Sample	Method	Client Sample Identity	Units	Matrix	Analyst
19060242-083	EPA 200.5 Rev 4.2	Rm 15 closet sink		Drinking Water	CharleneF

Start Date/Time Sampled: 6/25/2019 10:15:00 AM Composite End Date/Time:

Parameter	CAS Number	Result	Qualifier	Date/Time Analyzed	RDL	Analyst
Hot Plate Digestion				7/11/2019	0	harleneF
Lead	7439-92-1	< 0.003 mg/L		7/22/2019	0.003	BenN

Sample	Method	Client Sample Identity	Units	Matrix	Analyst
19060242-084	EPA 200.5 Rev 4.2	8th gr girls BR lft sink		Drinking Water	CharleneF

Start Date/Time Sampled: 6/25/2019 9:01:00 AM Composite End Date/Time:

Parameter	CAS Number	Result	Qualifier	Date/Time Analyzed	RDL	Analyst
Hot Plate Digestion				7/11/2019	0	harleneF
Lead	7439-92-1	< 0.003 mg/L		7/22/2019	0.003	BenN

Sample	Method	Client Sample Identity	Units	Matrix	Analyst
19060242-085	EPA 200.5 Rev 4.2	8th gr grls BR 2nd frm lft sink		Drinking Water	CharleneF

Start Date/Time Sampled: 6/25/2019 9:02:00 AM Composite End Date/Time:

Parameter	CAS Number	Result	Qualifier	Date/Time Analyzed	RDL	Analyst
Hot Plate Digestion				7/11/2019	0	harleneF
Lead	7439-92-1	0.008 mg/L		7/22/2019	0.003	BenN

Sample	Method	Client Sample Identity	Units	Matrix	Analyst
19060242-086	EPA 200.5 Rev 4.2	8th gr grls BR 3rd frm lft sink		Drinking Water	CharleneF

Start Date/Time Sampled: 6/25/2019 9:02:00 AM Composite End Date/Time:

Parameter	CAS Number	Result	Qualifier	Date/Time Analyzed	RDL	Analyst
Hot Plate Digestion				7/11/2019	0	harleneF
Lead	7439-92-1	0.008 mg/L		7/22/2019	0.003	BenN



317 Elm Street  
 Milford, NH 03055  
 (603) 673-5440  
 Sales@chemservelab.com

Sample	Method	Client Sample Identity	Units	Matrix	Analyst
19060242-087	EPA 200.5 Rev 4.2	8th gr grls BR 4th frm lft sink		Drinking Water	CharleneF

Start Date/Time Sampled: 6/25/2019 9:03:00 AM Composite End Date/Time:

Parameter	CAS Number	Result	Qualifier	Date/Time Analyzed	RDL	Analyst
Hot Plate Digestion				7/11/2019	0	harleneF
Lead	7439-92-1	0.015 mg/L		7/22/2019	0.003	BenN

Sample	Method	Client Sample Identity	Units	Matrix	Analyst
19060242-088	EPA 200.5 Rev 4.2	8th gr grls BR 5th frm lft sink		Drinking Water	CharleneF

Start Date/Time Sampled: 6/25/2019 9:03:00 AM Composite End Date/Time:

Parameter	CAS Number	Result	Qualifier	Date/Time Analyzed	RDL	Analyst
Hot Plate Digestion				7/11/2019	0	harleneF
Lead	7439-92-1	0.007 mg/L		7/22/2019	0.003	BenN

Sample	Method	Client Sample Identity	Units	Matrix	Analyst
19060242-089	EPA 200.5 Rev 4.2	8th gr grls BR 6th frm lft sink		Drinking Water	CharleneF

Start Date/Time Sampled: 6/25/2019 9:05:00 AM Composite End Date/Time:

Parameter	CAS Number	Result	Qualifier	Date/Time Analyzed	RDL	Analyst
Hot Plate Digestion				7/11/2019	0	harleneF
Lead	7439-92-1	0.015 mg/L		7/22/2019	0.003	BenN

Sample	Method	Client Sample Identity	Units	Matrix	Analyst
19060242-090	EPA 200.5 Rev 4.2	8th gr boys BR lft sink		Drinking Water	CharleneF

Start Date/Time Sampled: 6/25/2019 8:59:00 AM Composite End Date/Time:

Parameter	CAS Number	Result	Qualifier	Date/Time Analyzed	RDL	Analyst
Hot Plate Digestion				7/11/2019	0	harleneF
Lead	7439-92-1	< 0.003 mg/L		7/22/2019	0.003	BenN

Sample	Method	Client Sample Identity	Units	Matrix	Analyst
19060242-091	EPA 200.5 Rev 4.2	8th gr boys BR rgt sink		Drinking Water	CharleneF

Start Date/Time Sampled: 6/25/2019 8:58:00 AM Composite End Date/Time:

Parameter	CAS Number	Result	Qualifier	Date/Time Analyzed	RDL	Analyst
Hot Plate Digestion				7/11/2019	0	harleneF
Lead	7439-92-1	< 0.003 mg/L		7/22/2019	0.003	BenN

Sample	Method	Client Sample Identity	Units	Matrix	Analyst
19060242-092	EPA 200.5 Rev 4.2	8th gr WF		Drinking Water	CharleneF

Start Date/Time Sampled: 6/25/2019 8:54:00 AM Composite End Date/Time:

Parameter	CAS Number	Result	Qualifier	Date/Time Analyzed	RDL	Analyst
Hot Plate Digestion				7/11/2019	0	harleneF
Lead	7439-92-1	< 0.003 mg/L		7/22/2019	0.003	BenN

**Qualifier: Description:**

- B- Method blank contaminated with target analyte.
- B1- BOD had total oxygen loss. Result reported as ">"the highest dilution.
- B2- BOD had no oxygen loss. Result reported as "<" the lowest dilution.
- G- Reporting limit elevated due to matrix interference.
- H- Method prescribed holding time exceeded.
- J- Indicates an estimated value. Value is less than the quantitation limit.
- IL- Internal Standard(s) recovery was low due to matrix. Result may be biased high.
- IH- Internal Standard(s) recovery was high due to matrix. Result may be biased low.
- LH- Laboratory control spike(s) was high. Results may be biased high.
- LL- Laboratory control spike(s) was low. Results may be biased low.
- MH- Matrix spike recovery high due to matrix. Results may be biased high.
- ML- Matrix spike recovery low due to matrix. Results may be biased low.
- N- Non-target compound. Reported as a TIC.
- NC- Spike recovery was not calculated due to the concentration of the analyte being >4 times the concentration of the spike added.
- R- RPD outside acceptable recovery limits.
- RO- Sample received out of holding time.
- SH- Surrogate recovery high due to matrix
- SL- Surrogate recovery low due to matrix
- U- BOD/CBOD blank had an oxygen depletion greater than the suggested amount of 0.200.
- V- Sample pH for analysis was not within the required range when checked at time of analysis.
- Z- Too numerous to count (TNTC)

An "A" in the result column on the report indicates absent for presence/absent bacteria and a "P" indicates present for presence/absent bacteria.

(91)

19060242-002 7-11-19

Monitoring Location Identifier	Laboratory Sample Identifier	Sample Purpose	Field Activity Start Date	Field Activity Start Time	Sample Identifier	Sample Comments	Laboratory Identifier	Method	Test Method Reference	Analysis/Matrix	First Draw	Substance Name	Sampler Comments
Sch-22295	19060242-001	Sample - Routine	06-25-19	0847	LC	Nurses office sink	1009	200.5 or 200.B	USEPA	WATER	Y	LEAD	
Sch-22295	19060242-002	Sample - Routine		0848	KC	Nurses office BR on right sink	1009	200.5 or 200.B	USEPA	WATER	Y	LEAD	
Sch-22295	19060242-003	Sample - Routine		0849	KC	Nurses office BR on left sink	1009	200.5 or 200.B	USEPA	WATER	Y	LEAD	
Sch-22295	19060242-004	Sample - Routine		0850	KC	VP in office	1009	200.5 or 200.B	USEPA	WATER	Y	LEAD	
Sch-22295	19060242-005	Sample - Routine		0851	KC	Office kitchen sink	1009	200.5 or 200.B	USEPA	WATER	Y	LEAD	
Sch-22295	19060242-006	Sample - Routine		0852	KC	Office kitchen sink	1009	200.5 or 200.B	USEPA	WATER	Y	LEAD	
Sch-22295	19060242-007	Sample - Routine		0853	KC	Office kitchen sink	1009	200.5 or 200.B	USEPA	WATER	Y	LEAD	
Sch-22295	19060242-008	Sample - Routine		0854	KC	Office kitchen sink	1009	200.5 or 200.B	USEPA	WATER	Y	LEAD	
Sch-22295	19060242-009	Sample - Routine		0855	KC	Office kitchen sink	1009	200.5 or 200.B	USEPA	WATER	Y	LEAD	
Sch-22295	19060242-010	Sample - Routine		0856	KC	Office kitchen sink	1009	200.5 or 200.B	USEPA	WATER	Y	LEAD	
Sch-22295	19060242-011	Sample - Routine		0857	KC	VP next to Rm 52	1008	200.5 or 200.B	USEPA	WATER	Y	LEAD	
Sch-22295	19060242-012	Sample - Routine		0858	KC	Boys BR next to Rm 53 sink on left	1008	200.5 or 200.B	USEPA	WATER	Y	LEAD	
Sch-22295	19060242-013	Sample - Routine		0859	KC	Boys BR next to Rm 53 sink on right	1008	200.5 or 200.B	USEPA	WATER	Y	LEAD	
Sch-22295	19060242-014	Sample - Routine		0860	KC	Boys BR next to Rm 53 sink on right	1008	200.5 or 200.B	USEPA	WATER	Y	LEAD	
Sch-22295	19060242-015	Sample - Routine		0861	KC	Boys BR next to Rm 53 sink on right	1008	200.5 or 200.B	USEPA	WATER	Y	LEAD	
Sch-22295	19060242-016	Sample - Routine		0862	KC	Boys BR next to Rm 53 sink on right	1008	200.5 or 200.B	USEPA	WATER	Y	LEAD	
Sch-22295	19060242-017	Sample - Routine		0863	KC	Boys BR next to Rm 53 sink on right	1008	200.5 or 200.B	USEPA	WATER	Y	LEAD	
Sch-22295	19060242-018	Sample - Routine		0864	KC	Boys BR next to Rm 53 sink on right	1008	200.5 or 200.B	USEPA	WATER	Y	LEAD	
Sch-22295	19060242-019	Sample - Routine		0865	KC	Boys BR next to Rm 53 sink on right	1008	200.5 or 200.B	USEPA	WATER	Y	LEAD	
Sch-22295	19060242-020	Sample - Routine		0866	KC	Boys BR next to Rm 53 sink on right	1008	200.5 or 200.B	USEPA	WATER	Y	LEAD	
Sch-22295	19060242-021	Sample - Routine		0867	KC	Boys BR next to Rm 53 sink on right	1008	200.5 or 200.B	USEPA	WATER	Y	LEAD	
Sch-22295	19060242-022	Sample - Routine		0868	KC	Boys BR next to Rm 53 sink on right	1008	200.5 or 200.B	USEPA	WATER	Y	LEAD	
Sch-22295	19060242-023	Sample - Routine		0869	KC	Boys BR next to Rm 53 sink on right	1008	200.5 or 200.B	USEPA	WATER	Y	LEAD	
Sch-22295	19060242-024	Sample - Routine		0870	KC	Boys BR next to Rm 53 sink on right	1008	200.5 or 200.B	USEPA	WATER	Y	LEAD	
Sch-22295	19060242-025	Sample - Routine		0871	KC	Boys BR next to Rm 53 sink on right	1008	200.5 or 200.B	USEPA	WATER	Y	LEAD	
Sch-22295	19060242-026	Sample - Routine		0872	KC	Boys BR next to Rm 53 sink on right	1008	200.5 or 200.B	USEPA	WATER	Y	LEAD	
Sch-22295	19060242-027	Sample - Routine		0873	KC	Boys BR next to Rm 53 sink on right	1008	200.5 or 200.B	USEPA	WATER	Y	LEAD	
Sch-22295	19060242-028	Sample - Routine		0874	KC	Boys BR next to Rm 53 sink on right	1008	200.5 or 200.B	USEPA	WATER	Y	LEAD	
Sch-22295	19060242-029	Sample - Routine		0875	KC	Boys BR next to Rm 53 sink on right	1008	200.5 or 200.B	USEPA	WATER	Y	LEAD	
Sch-22295	19060242-030	Sample - Routine		0876	KC	Boys BR next to Rm 53 sink on right	1008	200.5 or 200.B	USEPA	WATER	Y	LEAD	
Sch-22295	19060242-031	Sample - Routine		0877	KC	Boys BR next to Rm 53 sink on right	1008	200.5 or 200.B	USEPA	WATER	Y	LEAD	
Sch-22295	19060242-032	Sample - Routine		0878	KC	Boys BR next to Rm 53 sink on right	1008	200.5 or 200.B	USEPA	WATER	Y	LEAD	
Sch-22295	19060242-033	Sample - Routine		0879	KC	Boys BR next to Rm 53 sink on right	1008	200.5 or 200.B	USEPA	WATER	Y	LEAD	
Sch-22295	19060242-034	Sample - Routine		0880	KC	Boys BR next to Rm 53 sink on right	1008	200.5 or 200.B	USEPA	WATER	Y	LEAD	
Sch-22295	19060242-035	Sample - Routine		0881	KC	Boys BR next to Rm 53 sink on right	1008	200.5 or 200.B	USEPA	WATER	Y	LEAD	
Sch-22295	19060242-036	Sample - Routine		0882	KC	Boys BR next to Rm 53 sink on right	1008	200.5 or 200.B	USEPA	WATER	Y	LEAD	
Sch-22295	19060242-037	Sample - Routine		0883	KC	Boys BR next to Rm 53 sink on right	1008	200.5 or 200.B	USEPA	WATER	Y	LEAD	
Sch-22295	19060242-038	Sample - Routine		0884	KC	Boys BR next to Rm 53 sink on right	1008	200.5 or 200.B	USEPA	WATER	Y	LEAD	
Sch-22295	19060242-039	Sample - Routine		0885	KC	Boys BR next to Rm 53 sink on right	1008	200.5 or 200.B	USEPA	WATER	Y	LEAD	
Sch-22295	19060242-040	Sample - Routine		0886	KC	Boys BR next to Rm 53 sink on right	1008	200.5 or 200.B	USEPA	WATER	Y	LEAD	
Sch-22295	19060242-041	Sample - Routine		0887	KC	Boys BR next to Rm 53 sink on right	1008	200.5 or 200.B	USEPA	WATER	Y	LEAD	

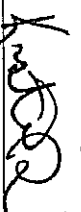
Reimbursed by:  Date/Time: 07/25/19 14:15 Received by Lab:  Date/Time: 07/25/19 14:15

1900000000

Sch-22295	19060242-042	Sample - Routine	062519	0452	CC	Rm 2 S sink	1008	200.5 or 200.8	USEPA	WATER	Y	LEAD
Sch-22295	19060242-043	Sample - Routine		0451	CC	Rm 2 N sink	1008	200.5 or 200.8	USEPA	WATER	Y	LEAD
Sch-22295	19060242-044	Sample - Routine		0130	CC	Rm 2 Toilet sink	1008	200.5 or 200.8	USEPA	WATER	Y	LEAD
Sch-22295	19060242-045	Sample - Routine				Rm 3 Toilet sink	1008	200.5 or 200.8	USEPA	WATER	Y	LEAD
Sch-22295	19060242-046	Sample - Routine		0451	CC	Rm 3 NW sink	1008	200.5 or 200.8	USEPA	WATER	Y	LEAD
Sch-22295	19060242-047	Sample - Routine		0451	CC	Rm 3 NE sink	1008	200.5 or 200.8	USEPA	WATER	Y	LEAD
Sch-22295	19060242-048	Sample - Routine		0451	CC	Rm 3 N Ck sink	1008	200.5 or 200.8	USEPA	WATER	Y	LEAD
Sch-22295	19060242-049	Sample - Routine		0451	CC	Rm 3 SW sink	1008	200.5 or 200.8	USEPA	WATER	Y	LEAD
Sch-22295	19060242-050	Sample - Routine		0451	CC	Rm 3 SE sink	1008	200.5 or 200.8	USEPA	WATER	Y	LEAD
Sch-22295	19060242-051	Sample - Routine		0451	CC	Rm 20 sink on flt	1008	200.5 or 200.8	USEPA	WATER	Y	LEAD
Sch-22295	19060242-052	Sample - Routine		0451	CC	Rm 20 sink on rgl	1008	200.5 or 200.8	USEPA	WATER	Y	LEAD
Sch-22295	19060242-053	Sample - Routine		0451	CC	Sluit BR in Bldg of Wing sink	1008	200.5 or 200.8	USEPA	WATER	Y	LEAD
Sch-22295	19060242-054	Sample - Routine				Rm 5 sink on flt	1008	200.5 or 200.8	USEPA	WATER	Y	LEAD
Sch-22295	19060242-055	Sample - Routine				Rm 5 sink on rgl	1008	200.5 or 200.8	USEPA	WATER	Y	LEAD
Sch-22295	19060242-056	Sample - Routine		0910	CC	Rm 4 sink on flt	1008	200.5 or 200.8	USEPA	WATER	Y	LEAD
Sch-22295	19060242-057	Sample - Routine		0910	CC	Rm 4 sink on rgl	1008	200.5 or 200.8	USEPA	WATER	Y	LEAD
Sch-22295	19060242-058	Sample - Routine		0955	CC	Rm 12 NW sink	1008	200.5 or 200.8	USEPA	WATER	Y	LEAD
Sch-22295	19060242-059	Sample - Routine		0555	CC	Rm 12 NE sink	1008	200.5 or 200.8	USEPA	WATER	Y	LEAD
Sch-22295	19060242-060	Sample - Routine		0556	CC	Rm 12 SE sink	1008	200.5 or 200.8	USEPA	WATER	Y	LEAD
Sch-22295	19060242-061	Sample - Routine		0556	CC	Rm 12 SW sink	1008	200.5 or 200.8	USEPA	WATER	Y	LEAD
Sch-22295	19060242-062	Sample - Routine		0557	CC	Rm 12 Toilet sink	1008	200.5 or 200.8	USEPA	WATER	Y	LEAD
Sch-22295	19060242-063	Sample - Routine		0600	CC	Rm 22 flt sink	1008	200.5 or 200.8	USEPA	WATER	Y	LEAD
Sch-22295	19060242-064	Sample - Routine		0600	CC	Rm 13 NW sink	1008	200.5 or 200.8	USEPA	WATER	Y	LEAD
Sch-22295	19060242-065	Sample - Routine		0600	CC	Rm 13 NE sink	1008	200.5 or 200.8	USEPA	WATER	Y	LEAD
Sch-22295	19060242-066	Sample - Routine		0600	CC	Rm 13 SE sink	1008	200.5 or 200.8	USEPA	WATER	Y	LEAD
Sch-22295	19060242-067	Sample - Routine		0600	CC	Rm 13 SW sink	1008	200.5 or 200.8	USEPA	WATER	Y	LEAD
Sch-22295	19060242-068	Sample - Routine		0600	CC	Rm 13 Toilet sink	1008	200.5 or 200.8	USEPA	WATER	Y	LEAD
Sch-22295	19060242-069	Sample - Routine		0600	CC	Sluit Kitchen sink	1008	200.5 or 200.8	USEPA	WATER	Y	LEAD
Sch-22295	19060242-070	Sample - Routine		0600	CC	Sluit BR sink in allit kitchen	1008	200.5 or 200.8	USEPA	WATER	Y	LEAD
Sch-22295	19060242-071	Sample - Routine		0600	CC	Kitchen 3 bay sink	1008	200.5 or 200.8	USEPA	WATER	Y	LEAD
Sch-22295	19060242-072	Sample - Routine		0600	CC	3 bay sink in kitchen	1008	200.5 or 200.8	USEPA	WATER	Y	LEAD
Sch-22295	19060242-073	Sample - Routine		0600	CC	Kitchen hose sink	1008	200.5 or 200.8	USEPA	WATER	Y	LEAD
Sch-22295	19060242-074	Sample - Routine		0600	CC	Kitchen hand wash sink	1008	200.5 or 200.8	USEPA	WATER	Y	LEAD
Sch-22295	19060242-075	Sample - Routine		0600	CC	Rm 37 N sink	1008	200.5 or 200.8	USEPA	WATER	Y	LEAD
Sch-22295	19060242-076	Sample - Routine		0600	CC	Rm 37 S sink	1008	200.5 or 200.8	USEPA	WATER	Y	LEAD
Sch-22295	19060242-077	Sample - Routine		0600	CC	gym BR wash wash	1008	200.5 or 200.8	USEPA	WATER	Y	LEAD
Sch-22295	19060242-078	Sample - Routine		0600	CC	gym BR WF	1008	200.5 or 200.8	USEPA	WATER	Y	LEAD
Sch-22295	19060242-080	Sample - Routine		0600	CC	gym locker Rm BR sink	1008	200.5 or 200.8	USEPA	WATER	Y	LEAD
Sch-22295	19060242-081	Sample - Routine		0600	CC	gym locker Rm BR sink	1008	200.5 or 200.8	USEPA	WATER	Y	LEAD
Sch-22295	19060242-082	Sample - Routine		0600	CC	Rm 15 class sink	1008	200.5 or 200.8	USEPA	WATER	Y	LEAD
Sch-22295	19060242-083	Sample - Routine		0600	CC	bln or gba BR flt sink	1008	200.5 or 200.8	USEPA	WATER	Y	LEAD
Sch-22295	19060242-084	Sample - Routine		0600	CC	bln or gba BR rgl sink	1008	200.5 or 200.8	USEPA	WATER	Y	LEAD
Sch-22295	19060242-085	Sample - Routine		0600	CC	bln or gba BR 2nd from flt sink	1008	200.5 or 200.8	USEPA	WATER	Y	LEAD

Requisitioned By: [Signature]

Date/TIME: 14:15

Received By: [Signature]

Date/TIME: 6-25-19





# South Meadow School

108 Hancock Rd.

Peterborough, NH 03458

(603) 924-7105

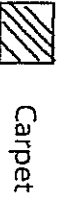
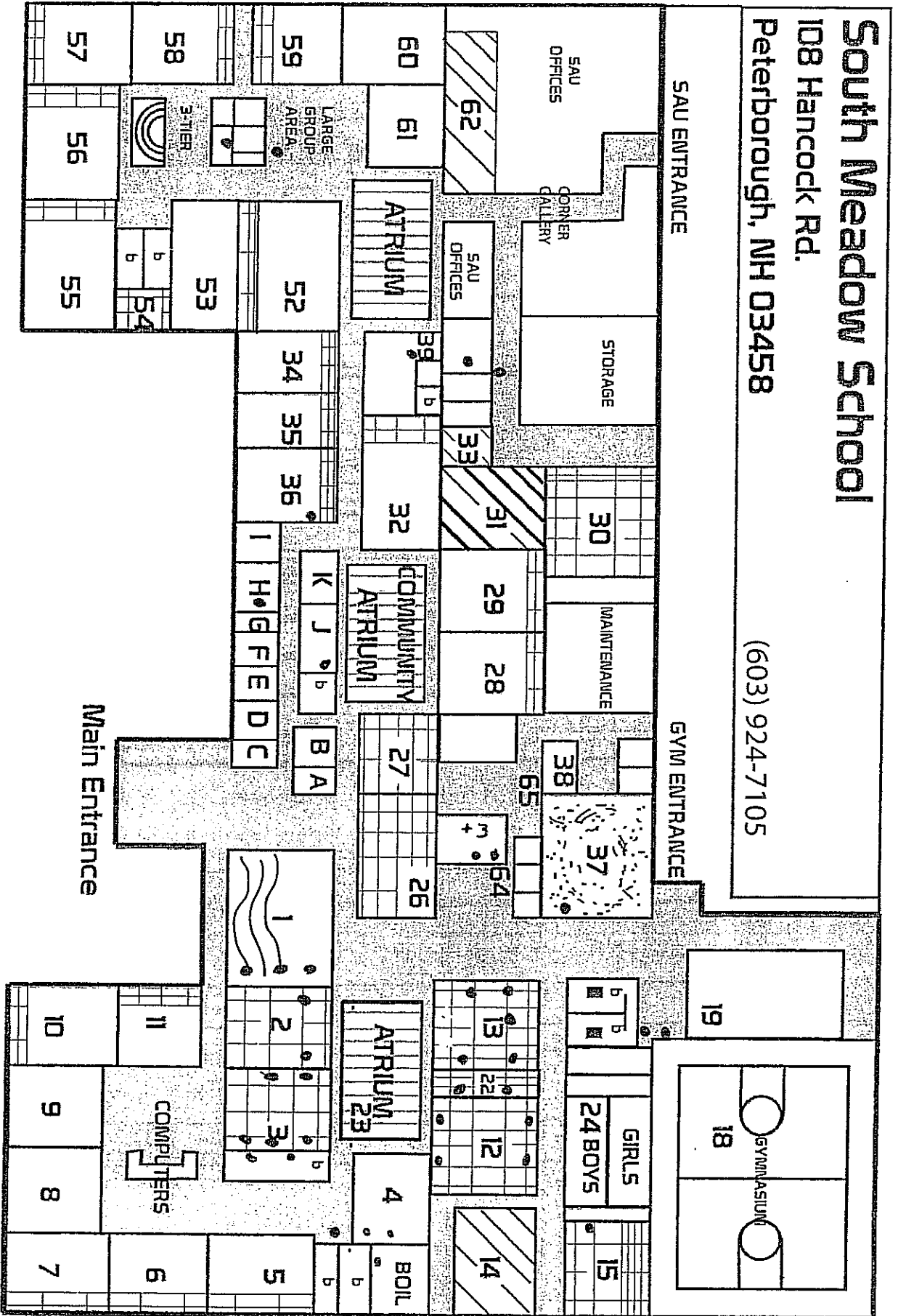

Carpet



Painted



Tile



Cement

17  
MUSIC  
CHOIR

16  
MUSIC